

A125FC-RGA

Class 125

2"~24"



SPECIFICATION

RISING STEM · OUTSIDE SCREW AND YOKE

MSS SP-70 · FLANGED TO ANSI CLASS 125

PRESSURE / TEMPERATURE RATINGS

	2"~12"	14"~24"
Working Pressure	200 psi	150 psi
Testing Pressure	Shell : 350 psi Seat : 200 psi	Shell : 262 psi Seat : 150 psi
Working Temperature	14 °F to 248 °F	
Suitable Media	Water, Oil & Gas	

* 200 psi pressure rating is available for 14"~24". The body material shall be Ductile Iron.

MATERIALS

Part	Material	ASTM
Body	Cast Iron	A126 Class B
Bonnet	Cast Iron	A126 Class B
Disc	Cast Iron	A126 Class B
Seat Ring	Gunmetal	B62 C83600
Stem	Brass Stainless Steel	B16 C36000 AISI 420
Packing	Graphite	Non-Asbestos
Handwheel	Cast Iron	A126 Class B

DIMENSIONS

Size inch	L inch	H (Open) inch	D inch
2	7	15.9	7.5
2-1/2	7.5	16.3	7.5
3	8	19.1	7.5
4	9	24.9	11.8
5	10	28	11.8
6	10.5	33.1	13.8
8	11.5	43.3	13.8
10	13	48.3	15.7
12	14	54.1	17.7
14	15	62.8	20
16	16	74.8	22
18	17	87	24
20	18	98	24
24	20	116.5	30

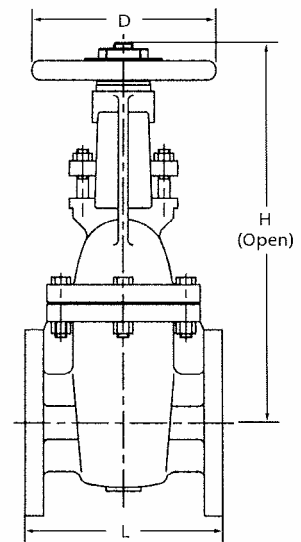

Note:

1. Other specifications and flange standards are available upon request.
2. Design and specifications are subject to change without prior notice.